

[www.delonghi.com](http://www.delonghi.com)



**Instructions for use**  
Keep these instructions

**Mode d'emploi**  
Conservez cette notice

**PORTABLE AIR CONDITIONER**  
**CONDITIONNEUR D'AIR PORTATIF**

**PAC AN130HPE**



Register this product online  
Visit **[www.delonghiregistration.com](http://www.delonghiregistration.com)**  
Visit **[www.delonghi.com](http://www.delonghi.com)** for a list of  
service centers near you.

Enregistrez ce produit en ligne  
Visitez **[www.delonghiregistration.com](http://www.delonghiregistration.com)**  
Visitez **[www.delonghi.com](http://www.delonghi.com)** pour y voir  
une liste des centres de réparation pro-  
ches de chez vous.

Electrical Specifications - Données électriques  
115 V~ 60 Hz 10.8 A

# Description

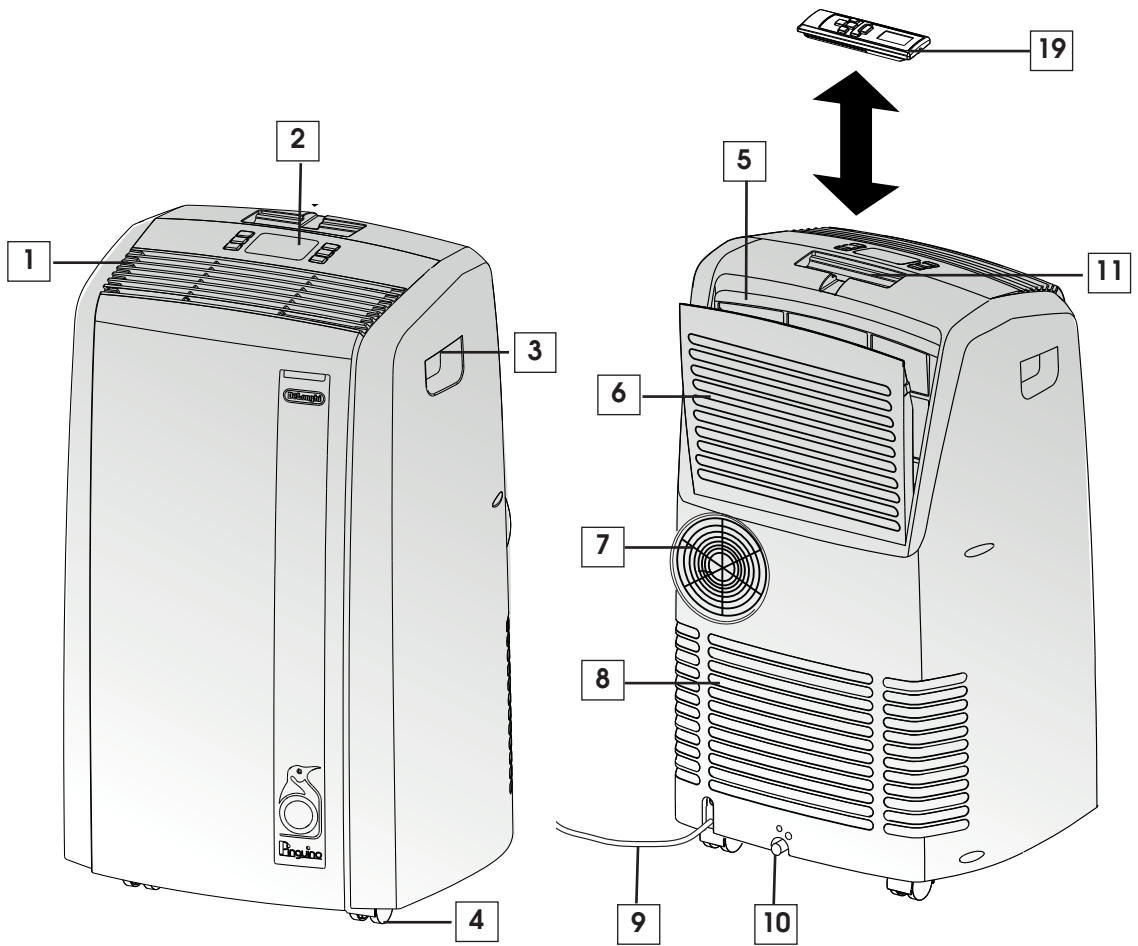

## • ACCESSORIES • ACCESSOIRES

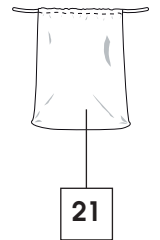
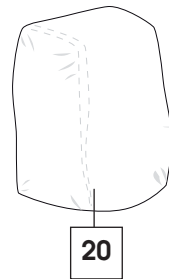
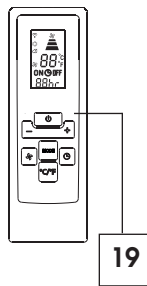
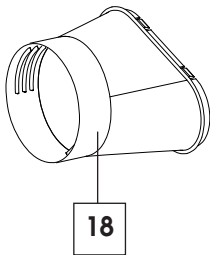
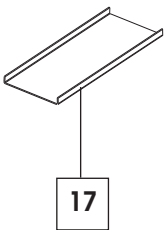
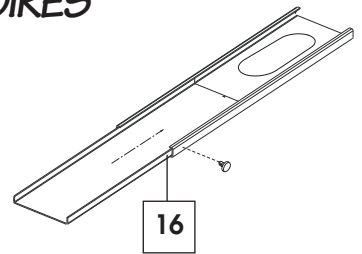
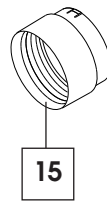
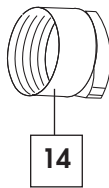
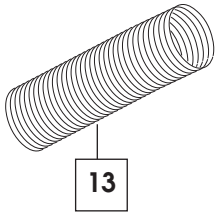
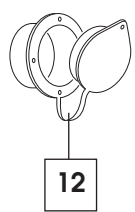

# Important safeguards

- Use this appliance only as described in this instruction manual.  
As with any electrical appliance, the instructions aim to cover as many situations as possible. Caution and common sense should be used when operating and installing this air conditioner.
- This appliance has been manufactured to cool and dehumidify domestic environments and must not be used for other purposes.
- It is dangerous to alter or modify the unit's characteristics in any way.
- The appliance must be installed in accordance with the relevant national legislation.
- Should repairs be necessary, contact the nearest authorized Repair Service Center. Unauthorized servicing can be dangerous.
- The appliance is not intended for use by persons (including children) with reduced physical, sensory or mental capabilities, or lack of experience and knowledge, unless they have been given supervision or instruction concerning use of the appliance by a person responsible for their safety.  
Children should be supervised to ensure that they do not play with the appliance.
- In the case that the power cord becomes damaged, this must be repaired only by specialized personnel authorized by the manufacturer in order to protect against fire.
- Always ensure the appliance is plugged into a grounded 3-prong outlet. If you have any doubts check with a qualified electrician.
- We strongly discourage the use of an extension cord due to potential safety hazards.
- Before cleaning or maintenance operations, always unplug the unit from the outlet.
- Do not pull on or place strain on the power cord when moving the appliance.
- The appliance should not be installed where the atmosphere may contain combustible gases, oil or sulphur, or near heat sources.
- Do not rest hot or heavy objects on the appliance.
- Clean the filters at least once a week.
- Avoid using heaters near the unit.
- The unit should be transported in a vertical position. If this is not possible secure the unit at an angle, do not lie it horizontally.
- Before transporting the unit, drain the unit. After transportation, wait at least 6 hours before switching the unit on.
- The packaging materials can be recycled. You are therefore recommended to place them in the special containers for differentiated waste collection.
- This appliance is fitted with a special safety device. When the compressor switches off, this device prevents it from switching on again for at least 3 minutes.
- **WARNING:** Changes or modifications not expressly approved by the party responsible for compliance could void the user's authority to operate the equipment.

## SAVE THESE INSTRUCTIONS

THIS PRODUCT IS FOR HOUSEHOLD ONLY

# Preparing for use

## DESCRIPTION

- |    |                              |    |                               |
|----|------------------------------|----|-------------------------------|
| 1  | air outlet grille            | 11 | remote control compartment    |
| 2  | control panel                | 12 | wall flange with cap          |
| 3  | handles                      | 13 | air exhaust hose              |
| 4  | castors                      | 14 | hose adaptor                  |
| 5  | filter                       | 15 | accessory for wall mounting   |
| 6  | evaporator air intake grille | 16 | window bracket with pins      |
| 7  | air exhaust hose housing     | 17 | additional window bracket     |
| 8  | condenser air intake grille  | 18 | window outlet                 |
| 9  | power cable                  | 19 | remote control                |
| 10 | drainage with 2 caps         | 20 | end of season dust cover      |
|    |                              | 21 | end of season accessories bag |

## ELECTRICAL CONNECTIONS

Before plugging the appliance into the electrical receptacle, check that:

- The outlet's power supply corresponds to the value indicated on the rating label on the back of the appliance;
- The outlet and electrical circuit are adequate for the appliance;
- The outlet is a 3-hole grounded outlet (⚡). If this is not the case, you must choose another outlet.

**Failure to follow these important safety instructions absolves the manufacturer of all liability.**

**The power cable must be replaced by a qualified professional only.**

The instructions below will enable you to prepare your air conditioner for operation as efficiently as possible.

**Before use, make sure the air intake and outlet grilles are unobstructed.**

## AIR-CONDITIONING WITHOUT INSTALLATION

Just a few simple steps and your comfort is ensured with your air conditioner:

- Screw the hose adaptor [14] to the hose's end [13].
- Fit the air exhaust hose in the housing at the back of the appliance. Insert it as shown in figure A. Be sure it is properly fixed (check by pulling lightly the hose).

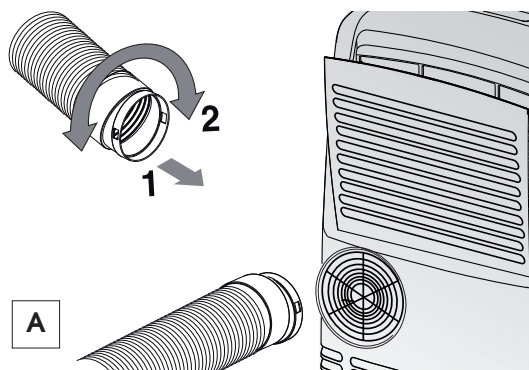

- Screw the window outlet [18] to the other end of the exhaust hose. (see fig. B).

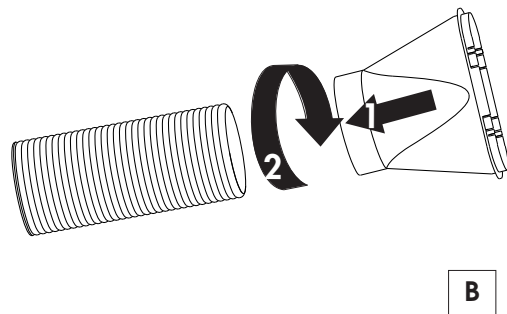

## Sash window

- Open the window.
- Place the window bracket [16] in the window, extending it to fit the width of the window (fig. C).
- Place the air conditioner near the window. Insert the assembled exhaust hose [13] into the window bracket hole [16].
- Make sure the air exhaust hose is unobstructed.
- If you have a very large window, in order to cover your window aperture, use the additional window bracket without holes extending it to the desired dimension,

# Preparing for use

then fix the bracket by using the locking pin provided. When extracting the window bracket and joining the two pieces pay attention you do not cover the hole.



## Other set-up methods:

- Thanks to the locking pin, it's possible to use the window bracket also for sliding windows. Position the hole of the bracket so to allow a correct installation of the exhaust hose (see figure D).



Keep the air hoses as short and free of curves as possible to avoid constrictions.

## French window

- After having screwed the window outlet **18** into the air exhaust hose **13**, open the French window slightly and position the window outlet **18** as shown in figure E.

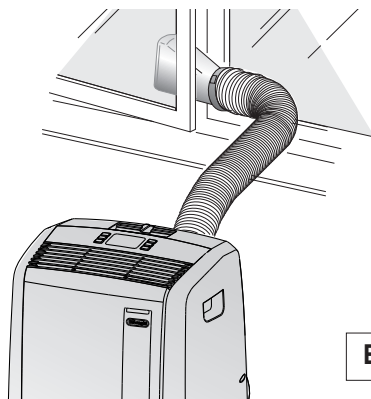

Keep the air hoses as short and free of curves as possible to avoid bottlenecks.

## SEMI-PERMANENT INSTALLATION

If required, your appliance can also be installed semi-permanently (Fig. F).

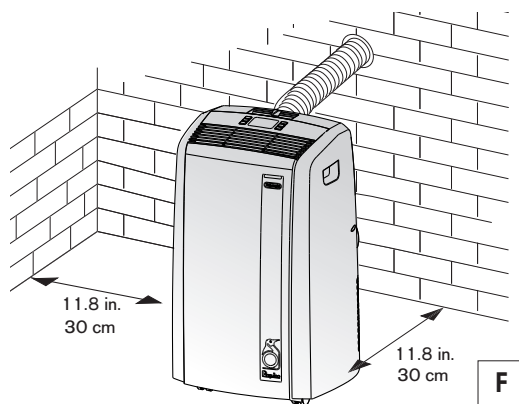

Proceed as follows:

- Drill a hole ( $\varnothing 134\text{mm}$  / 5,27 in.) in an outside wall or through a window pane. Respect the height and dimensions of the hole given in figures F and G.

**NOTE:** As special tools are required for installation, we suggest you have the appliance installed by specialized personnel.

# Preparing for use

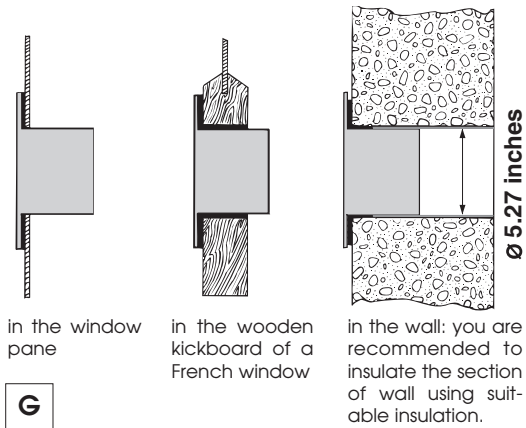

When the hose **13** is not fitted, the hole can be closed with the flange cap **12**.

**NOTE:** When installing the air conditioner semi-permanently, you should leave a door slightly open (as little as 0.39 inches - 1 cm) to guarantee correct ventilation.

- Fit the wall flange **21** into the hole.
- Screw the hose adaptor **14** to the hose's end **13**.
- Fit the air exhaust hose in the housing at the back of the appliance as shown in figure **A**.
- Screw the wall mounting accessory **15** into the hose **13** (fig. **H**) and fit it into the wall flange **12** as shown in fig. **I**.

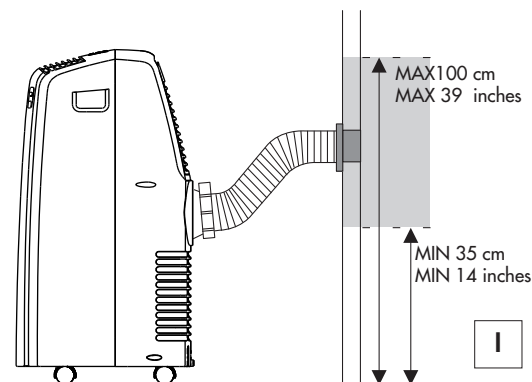
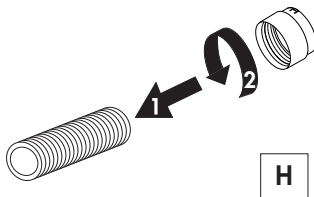

# Control panel

## THE CONTROL PANEL

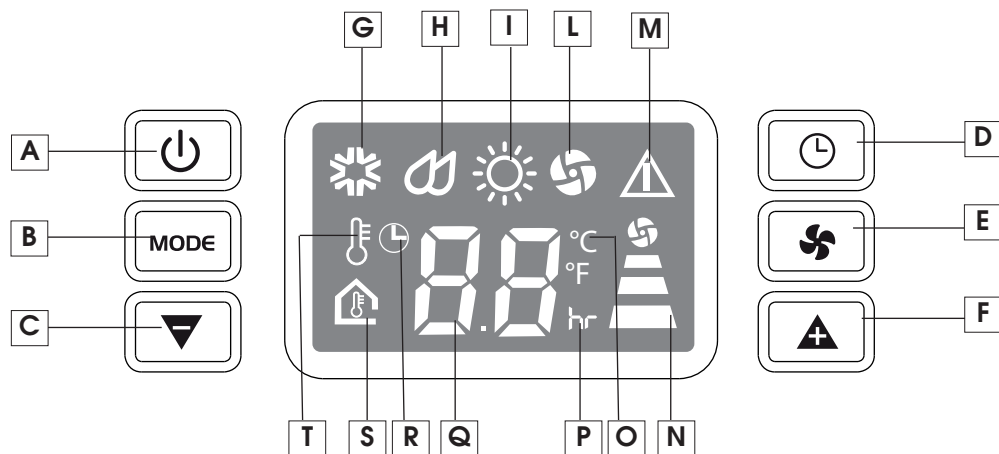

## DESCRIPTION OF THE CONTROL PANEL

- A** ON /OFF button
- B** MODE selection button  
Air conditioning, dehumidifying, heating, fan
- C** Reduce temperature/programme mode time button
- D** Timer button
- E** Fan speed button (MAX/MED/MIN)
- F** Increase temperature/programme mode time button
- G** Air conditioning symbol
- H** Dehumidifying symbol
- I** Heating symbol
- L** Fan symbol
- M** Alarm symbol
- N** Fan speed indicator
- O** Temperature scale indicator
- P** Time indicator
- Q** Set temperatures, room temperature and programmed on/off time
- R** Timer symbol
- S** Room temperature symbol
- T** Set temperature symbol

✓ Never turn the air conditioner off by unplugging from the outlet. Always press the  button, then wait for a few minutes before unplugging. This allows the appliance to perform a cycle of checks to verify operation



# Operation

**Before plugging the appliance check: the caps on the back of the unit are correctly inserted and screwed on the drainage 10.**

## TURNING THE APPLIANCE ON

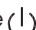
Plug the appliance into the electrical receptacle. Two lines appear on the display indicating that the appliance is in stand-by. Press the  button (A).

The first time the appliance is turned on, it will be in air conditioning mode. Room temperature will be displayed and fan speed will be at minimum. When turned on subsequently it will be in the same mode as when last turned off.

Press the **MODE** button (B) until the symbol corresponding to the required mode is displayed:

 **Air conditioning** symbol (G)

 **Dehumidifying** symbol (H)



 **Heating** symbol (I)

 **Fan** symbol (L)

## AIR CONDITIONING MODE

Ideal for hot muggy weather when you need to cool and dehumidify the room.

To set this function correctly:

- Press the MODE button a number of times until the air conditioning symbol appears. Room temperature is displayed.
- Select the target temperature by pressing the  button (F) or  button (C) until the required value is displayed.

During selection, the temperature flashes.

After 10 seconds, room temperature is displayed again.

- Select the required fan speed by pressing the  button.

There are 3 speeds available:



**High speed:** to achieve the target temperature as rapidly as possible



**Medium speed:** reduces noise levels but still maintains a good level of comfort



**Low speed:** for silent operation

*The most suitable indoor temperature for the room during the summer varies from 75 to 81°F. You are recommended, however, not to set a temperature much below the outdoor temperature.*

## DEHUMIDIFYING MODE

Ideal to reduce room humidity (spring and autumn, damp rooms, rainy periods, etc). For this mode, the appliance should be prepared in the same way as for air conditioning, with the air exhaust hose attached to enable the moisture to be discharged outside.

To set this function correctly:

- Press the **MODE** button a number of times until the dehumidifying symbol appears.

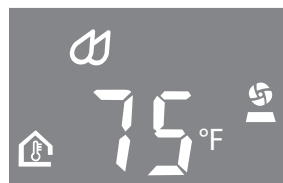

# Operation



**NOTE:** In this mode, with room temperature above 25 degree C, the fan speed is adjustable. If the temperature is below, fan speed is selected automatically by the appliance and cannot be set manually.

## HEATING MODE

This is ideal in spring and autumn when outdoor temperatures are not particularly severe.

For this mode, the appliance should be prepared in the same way as for air conditioning, with the air exhaust hose attached to enable the moisture to be discharged outside.

To set this function correctly:

- Press the **MODE** button a number of times until the heating symbol  appears.
- Select the required fan speed by pressing the  button.

There are 3 speeds available:



**High speed:** to achieve the target temperature as rapidly as possible



**Medium speed:** reduces noise levels but still maintains a good level of comfort





**Low speed:** for silent operation

**NOTE:** With particular room conditions (e.g. low temperature or high temperature), the appliance will automatically select the operating fan speed however, If the unit is cold, it will automatically perform a pre-heating cycle. It can take several minutes and fan will not operate until pre-heating cycle is over. **In this mode, the fan may operate for short periods, even though the set temperature has already been reached.**

## FAN MODES

When using the appliance in this mode, the air exhaust hose does not need to be attached.

To set this function correctly:

- Press the **MODE** button a number of times until the fan symbol  appears.
- Select the required fan speed by pressing the  button.

There are 3 speeds available:





**High speed:** for maximum fan power;



**Medium speed:** reduces noise levels but still maintains a good level of comfort;

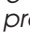

**Low speed:** for silent operation.

**PLEASE NOTE:** To change the unit of measurement for the displayed temperature, press the  and  buttons together for 3 seconds.

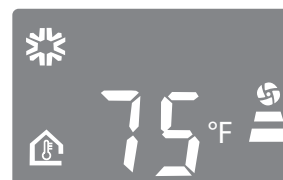

# Setting the timer

## SETTING THE TIMER

The timer can be used to delay when the appliance comes on or goes off. This avoids wasting electricity by optimising operating periods.

### How to programme delay ON

- Plug the appliance into an electrical receptacle. It will be in STAND-BY.
- Press the timer button (D). The timer symbol (R) comes on.
- Use the ▲ (F) or ▼ (C) buttons to set the number of hours delay before the appliance comes on. They increase or decrease the time in steps of an hour.

The appliance can be set to come on within the next 24 hours. Five seconds after the timer has been set, the display dims and the setting is memorised.

**PLEASE NOTE:** after setting, the operating mode and fan speed can be modified.

To cancel the timer programme, press the timer button (D) again.

Pressing the ON/OFF button (A) cancels the timer programme and the air conditioner comes on immediately in the selected mode.

### How to programme delay OFF

- Delay OFF can be programmed in any operating mode - air conditioning/fan/dehumidifying.
- Press the timer button (D). The timer on symbol (R) comes on.
- Use the ▲ (F) or ▼ (C) buttons to set the number of hours delay before the appliance goes off.

They increase or decrease the time in steps of an hour.

The appliance can be set to go off within the next 24 hours.

Five seconds after the timer has been set, the operating mode is displayed and the timer symbol remains on.

At the set time, the air conditioner goes off and remains in stand-by.

To cancel the timer programme, press the timer button (D) again. The timer symbol goes off.

**PLEASE NOTE:** after setting, the operating mode and fan speed can be modified.

## MODELS WITH REMOTE CONTROL

- Point the remote control at the receiver on the air conditioner. The remote control must be no more than 16,4 ft (5 metres) away from the appliance (without obstacles between the remote control and the receiver).
- The remote control must be handled with **extreme care**. Do not drop it or expose it to direct sunlight or sources of heat.
- Replace the cover.

**PLEASE NOTE:** The remote control can be safely stored in the appropriate compartment A12 (see figure).

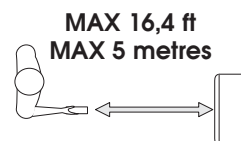
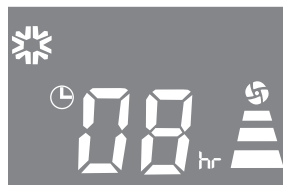

# Using the remote control unit

## DESCRIPTION OF THE REMOTE CONTROL

- 22) "ON/OFF" button
- 23) Temperature decrease/increase and programme mode button
- 24) "MODE" button
- 25) "TIMER" button
- 26) °F/°C switching button
- 27) Fan speed button (MAX/MED/MIN)

## Replacing the batteries

- Remove the cover on the back of the remote control;
- Insert two new LR03 "AAA" 1.5V batteries, making sure they are in the correct position (see the instructions inside the battery compartment);
- Replace the cover.

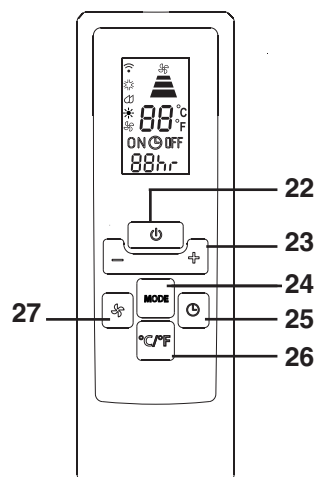

**If the remote control unit is replaced or discarded, the batteries must be removed and disposed of in accordance with current legislation as they are harmful to the environment. Do not mix old and new batteries. Do not mix alkaline, standard (carbon-zinc) or rechargeable (nickel-cadmium) batteries. Do not dispose of batteries in fire. Batteries may explode or leak. If the remote control will not be used for a certain length of time, remove the batteries.**

- **Note:** This equipment has been tested and found to comply with the limits for a Class B digital device, pursuant to part 15 of the FCC Rules. These limits are designed to provide reasonable protection against harmful interference in a residential installation.
- This equipment generates, uses and can radiate radio frequency energy and, if not installed and used in accordance with the instructions, may cause harmful interference to radio communications. However, there is no guarantee that interference will not occur in a particular installation. If this equipment does cause harmful interference to radio or television reception, which can be determined by turning the equipment off and on, the user is encouraged to try to correct the interference by one or more of the following measures:
  - Reorient or relocate the receiving antenna.
  - Increase the separation between the equipment and receiver.
  - Connect the equipment into an outlet on a circuit different from that to which the receiver is connected.
  - Consult the dealer or an experienced radio/TV technician for help.Changes or modifications not expressly approved by the party responsible for compliance could void the user's authority to operate the equipment.
- This device complies with Part 15 of the FCC Rules. Operation is subject to the following two conditions: (1) this device may not cause harmful interference, and (2) this device must accept any interference received, including interference that may cause undesired operation.
- This Class B digital apparatus complies with Canadian CAN ICES-3 (B) / NMB-3 (B).

## TURNING THE APPLIANCE ON

Plug the appliance into the electrical receptacle.

Press the **ON/OFF** button of the remote control (22) (when turned on, the air conditioner starts operating in the same mode as when last turned off).

Press the **MODE** button (24) button to select the required mode:

### AIR CONDITIONING (COOLING)

### DEHUMIDIFYING

### HEATING

### FAN ONLY

The light corresponding to the selected mode lights up on the control panel.

For air conditioning/dehumidifying/heating/fan only settings and programming the timer, see the paragraphs on page 9 - 11.

# Tips

To get the best from your air conditioner, follow these recommendations:

- close the doors and windows of the room to be air conditioned. The only exception is when the appliance is installed through a hole in the wall. In this case, you are recommended to leave a slight draught through a door or window to guarantee correct ventilation.
- Never use the appliance in very damp rooms (laundries for example).
- Never use the appliance outdoors.

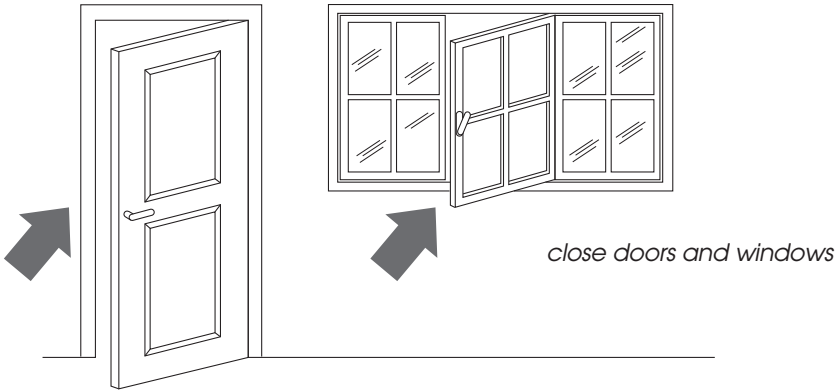

- Protect the room from direct exposure to the sun by partially closing curtains and/or blinds to make the appliance much more economical to run;
- Never rest objects of any kind on the air conditioner;
- Do not obstruct the air intake **6** or outlet **1**;
- Make sure there are no heat sources in the room.

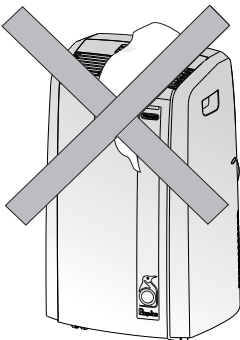
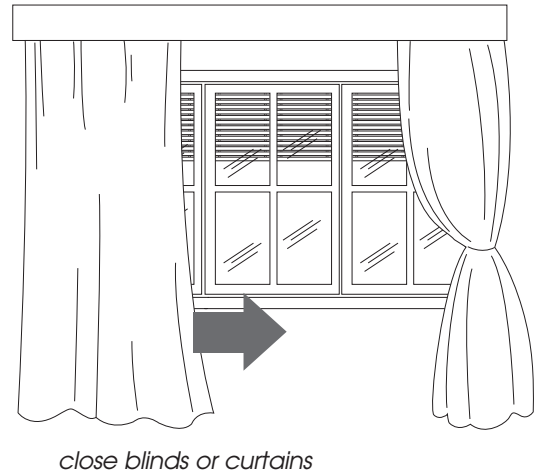

- Make sure the air conditioner is on a flat floor.

# Cleaning

**Before cleaning or maintenance, turn the appliance off by pressing the ON/OFF button (A) or in models with remote control, by pressing the ON/OFF button [22], then always unplug the appliance from the electrical receptacle.**

## CLEANING THE CABINET

You should clean the appliance with a slightly damp cloth then dry with a dry cloth. For safety reasons, never wash the air conditioner with water.

## Precautions

Never use petrol, alcohol or solvents to clean the appliance. Never spray insecticide liquids or similar.

## CLEANING THE SILVER ION AIR FILTER

If the filter is dirty, air circulation is compromised and the efficiency of the dehumidifying and air purifying functions decreases.

It is therefore good practice to clean the filter at regular intervals. The frequency depends on the duration and conditions of operation. If the unit is used constantly or systematically, you are recommended to clean the filter once a week.

The filter is housed in the intake grille.

To clean the filter, extract as shown in fig. L.

Use a vacuum cleaner to remove the dust collected on the filter. If it is very dirty, immerse in warm water and rinse a number of times. The water should never be hotter than 104°F.

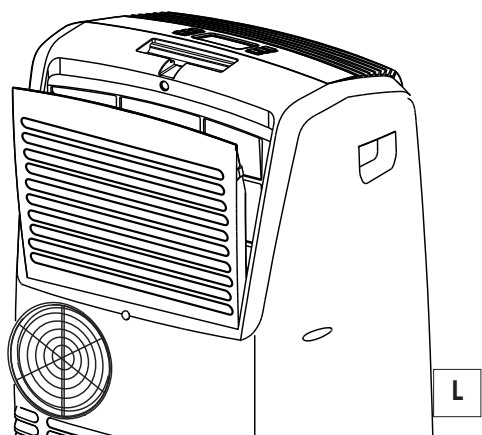

After washing the filter, allow it to dry completely before repositioning it.

The silver ion filter not just retains dust particles, but also has an efficient antibacterial action. It also greatly reduces concentrations of irritants such as pollen and spores.

## START OF SEASON CHECKS

Make sure the power cable and plug are undamaged and the ground connection is efficient. Follow the installation instructions precisely.

## END OF SEASON OPERATIONS

To drain all water from the circuit, remove the external cap by unscrewing it in the anti-clockwise direction then, remove the internal cap from the drainage [10] on the back of the appliance and allow the water to drain out into a basin (figure M).

When the appliance is empty, replace the caps.

Clean the filter and dry thoroughly before putting back.

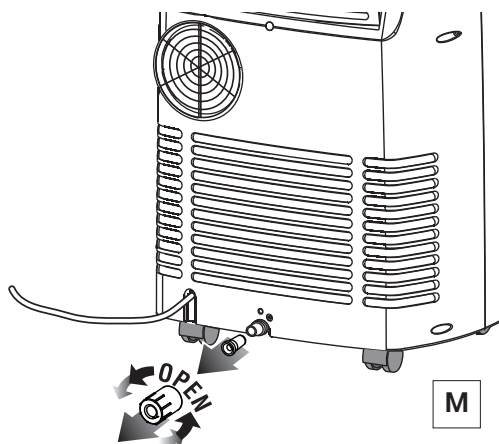

## END OF SEASON DUST COVER/ACCESSORIES BAG

In order to properly storage the appliance at the end of the season, we suggest you cover it with the supplied end of season dust cover



[20] and you put the accessories in the relevant end of season accessories bag [21].

# Troubleshooting

PROBLEM	CAUSE	REMEDY
<b>The air conditioner does not come on</b>	<ul style="list-style-type: none"> <li>there is no current</li> <li>the appliance is not plugged into the electrical receptacle</li> <li>The safety device of the plug has tripped</li> </ul>	<ul style="list-style-type: none"> <li>plug into the electrical receptacle</li> <li>reset the plug safety device, if problem persists contact our toll free customer service.</li> </ul>
<b>The air conditioner works for a short time only</b>	<ul style="list-style-type: none"> <li>the air exhaust hose has a constriction</li> <li>the air exhaust hose is blocked</li> <li>there are bends in the air exhaust hose</li> </ul>	<ul style="list-style-type: none"> <li>position the air exhaust hose correctly</li> <li>check there are no obstacles obstructing air discharge</li> <li>eliminate the bends</li> </ul>
<b>The air conditioner works, but does not cool the room</b>	<ul style="list-style-type: none"> <li>windows opened</li> <li>the exhaust hose is detached</li> <li>air filter clogged</li> </ul>	<ul style="list-style-type: none"> <li>close all windows. Only the window where the appliance is installed can remain slightly opened</li> <li>connect the exhaust hose</li> <li>clean or replace the filter</li> </ul>
<b>Heating Mode is selected, but fan doesn't work</b>	<ul style="list-style-type: none"> <li>air conditioner needs to warm up</li> </ul>	<ul style="list-style-type: none"> <li>wait several minutes for Pre-Heating Cycle to complete</li> </ul>
<b>Particular odour in the room</b>	<ul style="list-style-type: none"> <li>the air filter is clogged</li> </ul>	<ul style="list-style-type: none"> <li>clean or replace the filter</li> </ul>
<b>The air conditioner does not operate after restarting it</b>	<ul style="list-style-type: none"> <li>The safety device has tripped</li> </ul>	<ul style="list-style-type: none"> <li>wait for 3 minutes (it's due to a normal safety check)</li> </ul>
<b>The alarm light  (M) comes on</b>	<ul style="list-style-type: none"> <li>The tray under the appliance is full</li> </ul>	<ul style="list-style-type: none"> <li>empty the tray (see paragraph on end-of-season operations on page 14).</li> </ul>

## SELF-DIAGNOSIS

The appliance has a self diagnosis system to identify a number of malfunctions. Error messages are displayed on the appliance display.

IF THE APPLIANCE DISPLAYS...	IF THE APPLIANCE DISPLAYS...	IF THE APPLIANCE DISPLAYS...
 <p>"Low Temperature"</p> <p><b>...THIS MEANS:</b> room temperature is too low</p>	 <p>"High Temperature"</p> <p><b>...THIS MEANS:</b> room temperature is too high</p>	 <p>"Probe Failure"</p> <p><b>...THIS MEANS:</b> contact Customer Services.</p>

# Technical specification

## TECHNICAL CHARACTERISTICS:

Power supply voltage	see rating plate
Max. power input during air conditioning	"
Max. power input during heating	"
Refrigerant	"
Cooling capacity	"

## LIMIT CONDITIONS

Room temperature for air conditioning (with fans at maximum speed)	64 ÷ 104°F
Room temperature for heating	50 ÷ 77°F

**Transport, filling, cleaning, recovery and disposal of refrigerant should be performed by a technical service centre appointed by the manufacturer only.**

**The appliance should be disposed of by a specialist centre appointed by the manufacturer only.**

NEVER TRANSPORT OR TURN THE APPLIANCE UPSIDE DOWN OR ON ITS SIDE. IF THIS OCCURS, WAIT 6 HOURS BEFORE TURNING THE APPLIANCE ON, 24 HOURS IS RECOMMENDED. (After the unit has been on its side, oil needs to return to the compressor to ensure proper function. Without allowing the unit this time (6-24 hours) The unit may function for only a short time, and then the compressor will break down from lack of oil).

This appliance is equipped with a 3 prong grounded plug. The plug must be connected into an outlet that is properly installed and grounded in the accordance with all local codes and ordinances. Do not modify the plug provided with the appliance. If it will not fit the outlet, have a proper outlet installed by a qualified electrician or relocate the unit to a proper outlet.

If the household electrical supply does not meet the above specifications, or if you are not sure your home has an effective electrical ground, have a qualified electrician or your local electrical utility company check it and correct any problems.

## SAFETY PLUG

The appliance is fitted with a safety plug to protect the power cable.

If power is cut off, unplug from the outlet and make sure the power cable is undamaged.

If the cable is damaged, call the service center immediately.

If power cuts off frequently and the power cable is undamaged, contact a qualified electrician.

## OPERATION OF THE SAFETY PLUG

If the safety device incorporated in the plug trips and cuts off the power supply, check that the power cable and plug are not damaged.

If the power cable is undamaged, to restore operation press the "RESET" button.

To verify correct operation of the plug, press the "TEST" button periodically and make sure the appliance disconnects. If this is not the case, contact the service center.

To restore operation, press the "RESET" button.



# Limited Warranty

De'Longhi is the distributor of Kenwood home appliances.

**This warranty applies to all home appliances with De'Longhi or Kenwood brand names**

## LIMITED WARRANTY

We warrant each De'Longhi AIR CONDITIONER to be free from defects in material and workmanship. From the purchase date, our obligation under this warranty is to provide one (1) year free parts and labor on the entire AIR CONDITIONER, with an additional four (4) years free on any part of the sealed system consisting of the compressor, evaporator, condenser and factory connected refrigerant tubing. Labor and all other parts during the additional four (4) years warranty are to be paid by the owner. All AIR CONDITIONERS in need of repair are to be shipped to an authorized De'Longhi service center at the owner's expense, and De'Longhi will then incur the return shipping costs. After the first five (5) years of ownership, all expenses (all parts, labor and shipping) are to be paid by the owner of the unit. This warranty shall apply only if the AIR CONDITIONER is used in accordance with the factory directions that accompany it, and on an Alternating Current (AC) circuit. This warranty is in lieu of all other warranties and representations, expressed or implied, and all other obligations or liabilities on our part. We do not authorize any other person or company to assume for us any liability in connection with the sale or use of our AIR CONDITIONER. This warranty shall not apply to any AIR CONDITIONER that has been repaired or altered outside our factory nor shall it apply to any AIR CONDITIONER that has been subjected to misuse, negligence or accidents.

If repairs become necessary, see contact information below:

### **U.S. Residents:**

Please contact our toll free hotline at **1-800-322-3848**  
or log onto our website at [www.delonghi.com](http://www.delonghi.com)

### **CANADA Residents:**

Please contact our toll free hotline at **1-888-335-6644**  
or log onto our website at [www.delonghi.com](http://www.delonghi.com)

### **MEXICO Residents:**

Please contact our toll free hotline at **01-800-711-8805**  
or log onto our website at [www.delonghi.com](http://www.delonghi.com)

The above warranty is in lieu of all other express warranties and representations. All implied warranties are limited to the applicable warranty period set forth above. This limitation does not apply if you enter into an extended warranty with De'Longhi. Some states/countries do not allow limitations on how long an implied warranty lasts, so the above exclusions may not apply to you. De'Longhi does not authorize any other person or company to assume for it any liability in connection with the sale or use of its appliance.

### **How does country law apply?**

This warranty gives you specific legal rights, and you may also have other rights, which vary from state to state/country to country.